



Solutia Inc.
300 Birmingham Highway
Anniston, Alabama 36201
Tel 256-231-8447

September 21, 1999

Mr. Wm. Gerald Hardy, Chief
Hazardous Waste Branch
Land Division
Alabama Department of Environmental Management
1400 Coliseum Blvd
Montgomery, AL 36130-1463



**Re: Extension of North Side Cover
Solutia Inc. Anniston, AL Facility
EPA ID No. ALD 004 019 048**

Dear Mr. Hardy:

Solutia has recently purchased additional property on the north side of its facility in Anniston, Alabama. These newly acquired properties are all located on the north side of the Norfolk Southern railway tracks, east of the cover that was constructed as a Supplemental Interim Measure in the second half of 1998. The scope of that Interim Measure was described in a Work Plan that was approved by the Alabama Department of Environmental Management (ADEM) in a letter dated September 10, 1998. The final report on the construction of this and other Supplemental Interim Measures was submitted to ADEM on March 30, 1999.

Some of the newly purchased properties contain affected soils, as shown on the attached Figure 1. This Figure shows the extent of the existing cover constructed in 1998, together with the results of analyses of samples taken within the immediate project area. The new properties are primarily located between Parkwin and Clydesdale Avenues, south of West 10th Street. However, some additional property was also purchased on the east side of Clydesdale Avenue, between the railroad tracks and 11th Street.

The properties on the west side of Clydesdale Avenue all contain affected soils and, in order to contain these soils, we intend to extend the existing cover system to include these properties. The properties on the east side of the street are either paved, or do not contain affected soils. Consequently, a cover is not necessary in this area.

Since the proposed work is an extension of the existing cover, we intend to use the same design and construction details contained in the approved Supplemental Measures Work

September 21, 1999

Plan. Consequently, we assume that a new Work Plan will not be required and that this letter and the attached drawings will serve as an amendment to that Work Plan. With that assumption, the scope of the proposed additional work consists of the following activities:

- Prior to extending the cover, the 10 structures shown on Figure 2 will be demolished. As was done previously, each of the buildings will be inspected for asbestos and, if present, an asbestos abatement plan will be implemented. Air quality will be monitored in the immediate vicinity of each of the structures during demolition, and the demolition debris will be transported to a permitted landfill for disposal. Concrete floor slabs will be left in place, since they will be isolated by the cover to be placed over these properties.
- Following demolition, the existing soil cover will be extended to the approximate limits shown on Figure 3. It will consist of a geotextile fabric placed over the existing ground surface and covered by a minimum of 14 ins. of clean soil which will be hydroseeded to promote vegetative growth. In some limited areas shown on Figure 3, an asphalt cover will be constructed instead of the soil cover.
- The existing fence enclosing Solutia-owned property will be extended to include the additional properties on the west side of Clydesdale Avenue with a soil cover. Since the properties on the east side of the street are either paved with asphalt, or do not contain affected materials, fencing is not required in this area.
- An addendum to the Supplemental Interim Measures Report will be submitted to ADEM within 90 days of completion of the proposed construction.

We plan to begin demolition prior to the end of 1999 and intend to start construction of the cover extension in the Spring of 2000. Consequently, we look forward to receiving your approval of these plans in the near future.

Sincerely,
Solutia Inc.

Solutia Inc.

Alan G. Faust
Manager of Remedial Projects

LAND DIVISION
FILING INSTRUCTIONS

NOTATION

2-1-1968

Northside Storm Water Control and Cover Project

Existing Cover

Solutia Inc.
Anniston, Alabama

LEGEND

- Soil and Sediment Sampling Points
Above Screening Limit
- Soil and Sediment Sampling Points
Below Screening Limit
- ▬ Existing Cover Limits
- ▬ Major Roads
- ▬ Minor Roads
- ▬ Railroads
- ▬ Buildings
- ▬ Solutia Inc. Property
- ▬ Paved Surface

NOTES

This is a re-creation of Atiqu-7013 Figure 2 with minor edits.
Only samples within the project area are shown.

ZONE

Alabama East 101

SOURCE

Golder Associates (on-site base map)
USGS 1:24,000 Quad Maps

MAP PROJECTION

US State Plane

DATUM

NAD83

LOCATION MAP

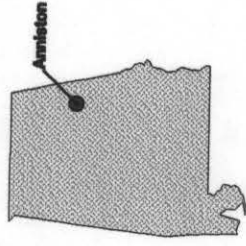

SCALE

1" = 200' (1:2,400)



DATE

PRODUCED BY:

QUERY NO.:

FIGURE NO.

21-Sep-1999

BSL

Atiqu-9039

1



Northside Storm Water
Control and Cover Project
Buildings To Be Demolished

Solutia Inc.
Anniston, Alabama

LEGEND

- Soil and Sediment Sampling Points Above Screening Limit
- Soil and Sediment Sampling Points Below Screening Limit
- Existing Cover Limits
- Buildings To Be Demolished
- Major Roads
- Minor Roads
- Railroads
- Buildings
- Solutia Inc. Property
- Paved Surface

NOTES

Only samples within the project area are shown.

ZONE

Alabama East 101

SOURCE

Golder Associates (on-site base map)
USGS 1:24,000 Quad Maps

MAP PROJECTION

US State Plane

DATUM

NAD83

LOCATION MAP

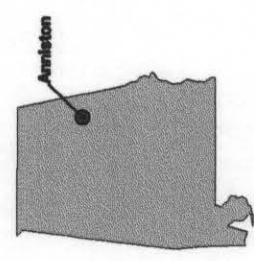

SCALE

1" = 200' (1:2,400)



DATE:

21-Sep-1999

PRODUCED BY:

BSL

QUERY NO.:

ASQU-0039

FIGURE NO.

2

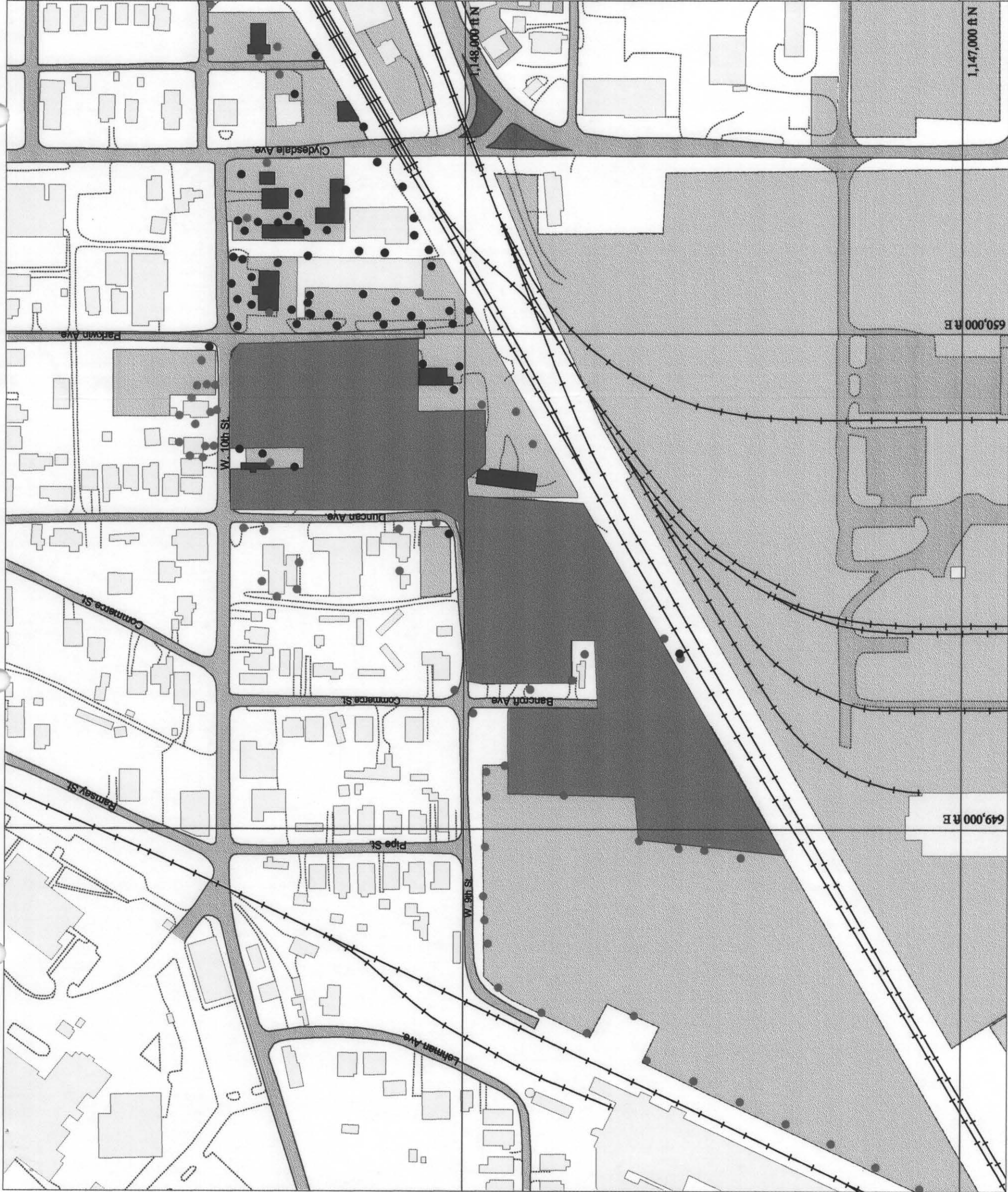

Northside Storm Water
Control and Cover Project

Areas To Be Covered

Solutia Inc.
Anniston, Alabama

LEGEND

- Soil and Sediment Sampling Points Above Screening Limit
- Soil and Sediment Sampling Points Below Screening Limit
- Existing Cover Limits
- Proposed Cover Limits - Soil
- Proposed Cover Limits - Asphalt
- ▤ Major Roads
- ▤ Minor Roads
- ▤ Railroads
- ▤ Buildings (circa Spring 2000)
- ▤ Solutia Inc. Property
- ▤ Paved Surface

NOTES

Only samples within the project area are shown.

ZONE

Alabama East 101

SOURCE

Golder Associates (on-site base map)
USGS 1:24,000 Quad Maps

MAP PROJECTION

US State Plane

DATUM

NAD83

LOCATION MAP

N

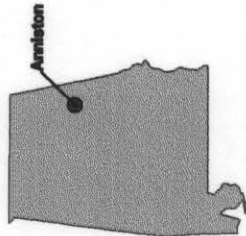

SCALE

1" = 200' (1:2,400)



DATE:

21-Sep-1999

PRODUCED BY:

BSL

QUERY NO.:

Alqu-9039

FIGURE NO.

3

